



# College of Engineering Interdisciplinary Education & Research Building

---

***BE BOUNDLESS***

# Goals & Objectives

---

- > Increase undergraduate enrollment by 1,000 and the addition of 40 tenure-track faculty (inc. associated research space).
- > Create a student-focused interdisciplinary center enabling the college to promote project-based learning and research, collaboration, and innovation for faculty and students in a curricular and co-curricular setting.
- > Enhance program excellence through increased student access and industry engagement.
- > Nurture campus/program connectivity through a prioritized phased framework of new construction, renovation, and strategically reallocated space.

# Goals & Objectives

---

- > **Increase undergraduate enrollment by 1,000 and the addition of 40 tenure-track faculty (inc. associated research space).**
- > **Create a student-focused interdisciplinary center enabling the college to promote project-based learning and research, collaboration, and innovation for faculty and students in a curricular and co-curricular setting.**
- > **Enhance program excellence through increased student access and industry engagement.**
- > **Nurture campus/program connectivity through a prioritized phased framework of new construction, renovation, and strategically reallocated space.**

# Project Overview

- > **\$100M Project Cost**
  - \$75M for new facility (+/- 75,000 GSF)
  - \$25M for a targeted renovation of Mechanical Engineering
- > **Funding split with State/Donor (50%/50%)**



# Background - Previous Planning Efforts

- > College of Engineering Strategic Plan 2014 - 2019
- > 2016 College of Engineering Space Assessment & Academic Facilities Plan – Office of the University Architect
- > 2018 College of Engineering Growth and Hive Site Development Study – Payette

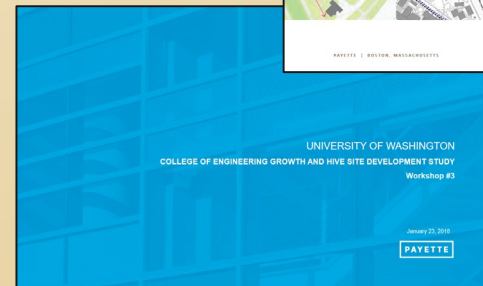

# Timeline

---

- > **Predesign: March 2018 – October 2018**
- > **Site Selection: March 2018 – March 2019**
- > **IDB Team Selection: Fall 2019 (funding dependent)**
- > **Design: Fall 2019 – Spring 2021 (funding dependent)**
- > **Permitting: Summer 2020 – Summer 2021**
- > **Construction: Summer 2021 – Summer 2023**
- > **Occupancy: Fall Quarter 2023**

# Timeline

---

- > **Predesign: March 2018 – October 2018**
- > **Site Selection: March 2018 – March 2019**
- > **IDB Team Selection: Fall 2019 (funding dependent)**
- > **Design: Fall 2019 – Spring 2021 (funding dependent)**
- > **Permitting: Summer 2020 – Summer 2021**
- > **Construction: Summer 2021 – Summer 2023**
- > **Occupancy: Fall Quarter 2023**

# Sites Considered



> Initially seven sites were considered



# Sites Considered



- > Initially seven sites were considered
- > Several sites eliminated after initial discussions

# Sites Considered

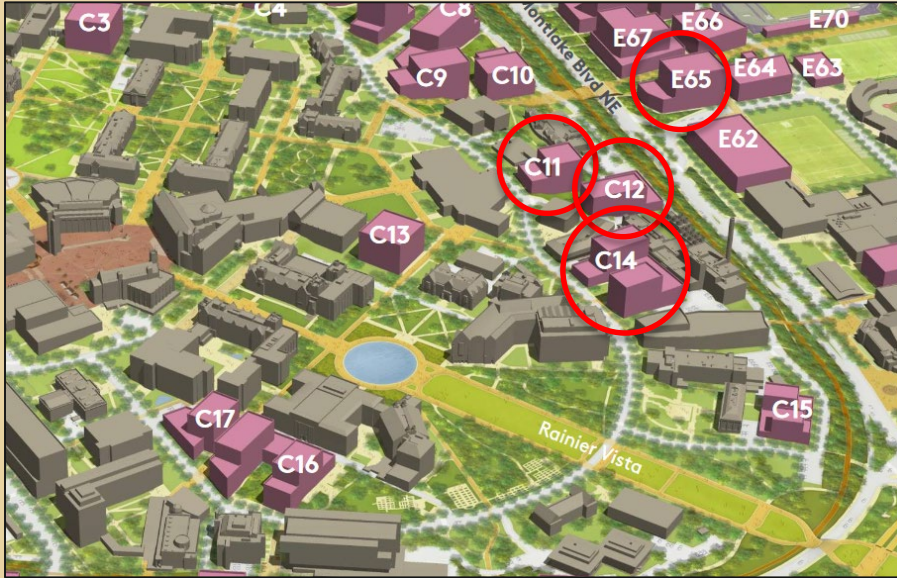

- > Initially seven sites were considered
- > Several sites eliminated after initial discussions
- > Site E65 added during final evaluation process

# Preferred Site

---



- > Location (proximity to Student Union Building)
- > Highly visible site
- > Enhance the existing pedestrian network
- > Maximizes the site capacity
- > Site topography

# Preferred Site



- > Location (proximity to Student Union Building)
- > Highly visible site
- > Enhance the existing pedestrian network
- > Maximizes the site capacity
- > Site topography
  - potential of high bay/daylight access on eastern facade

# Challenges

---

- > **Site topography (grade change)**
- > **View corridors**
- > **Pedestrian connections (inc. ADA)**
- > **UW Club**
- > **Jefferson Road and Stevens Way intersection**
- > **Defining building entry**
- > **Utilities**
- > **Enabling moves**

# Challenges

---

- > **Site topography (grade change)**
- > **View corridors**
- > **Pedestrian connections (inc. ADA)**
- > **UW Club**
- > **Jefferson Road and Stevens Way intersection**
- > **Defining building entry**
- > **Utilities**
- > **Enabling moves**

# Site Topography

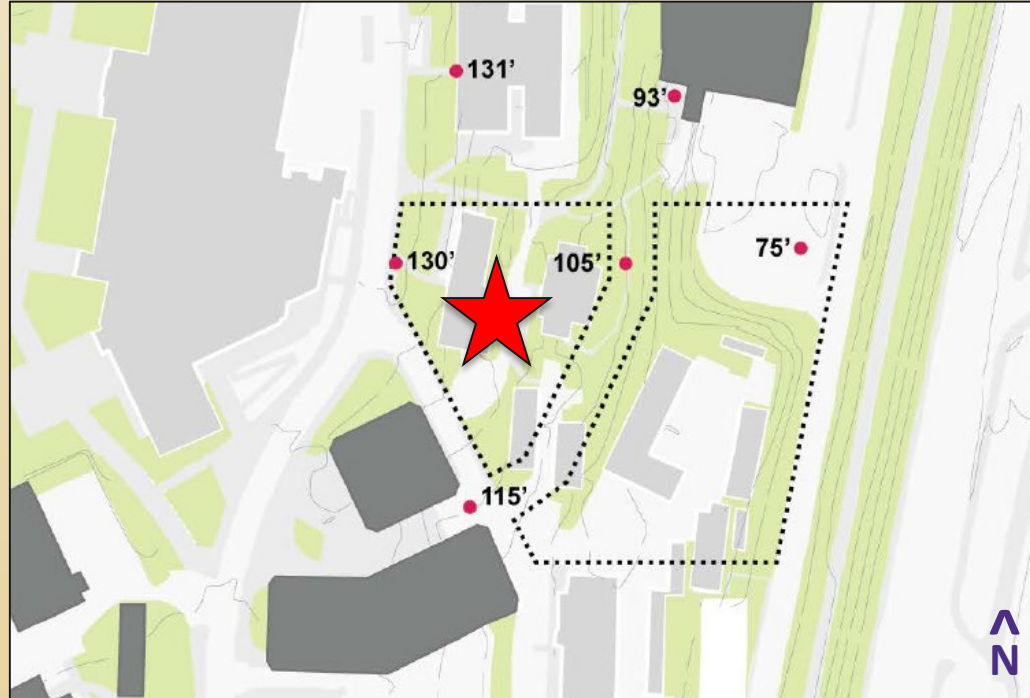

# View Corridors

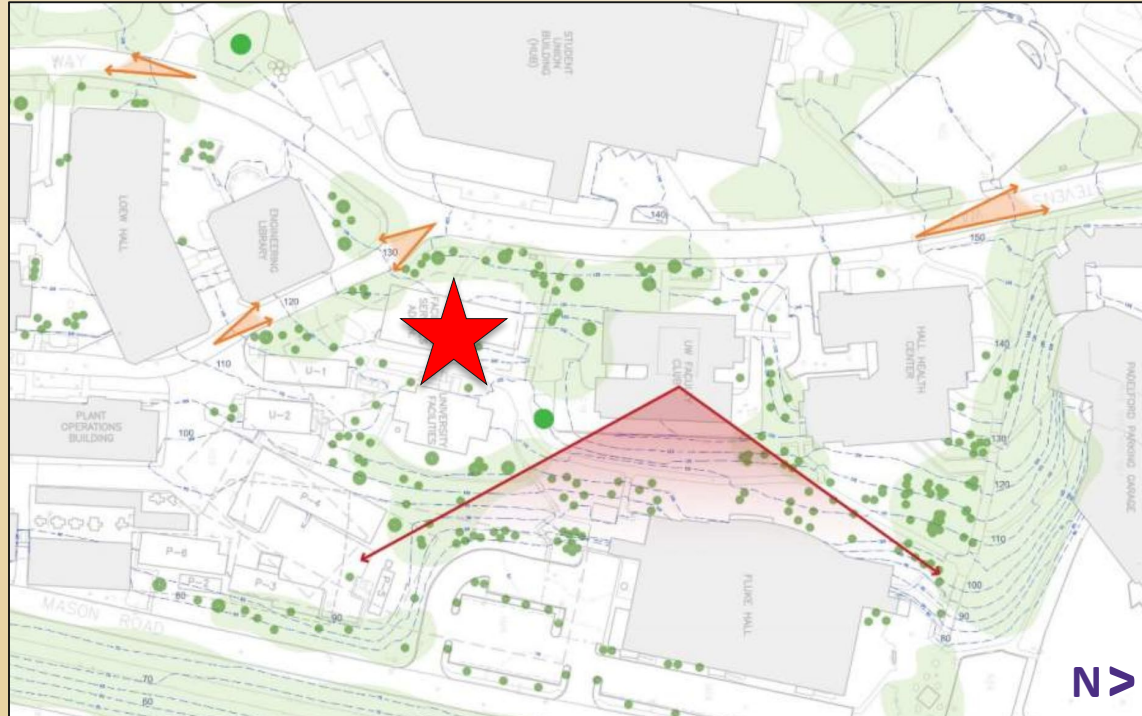



# View Corridors

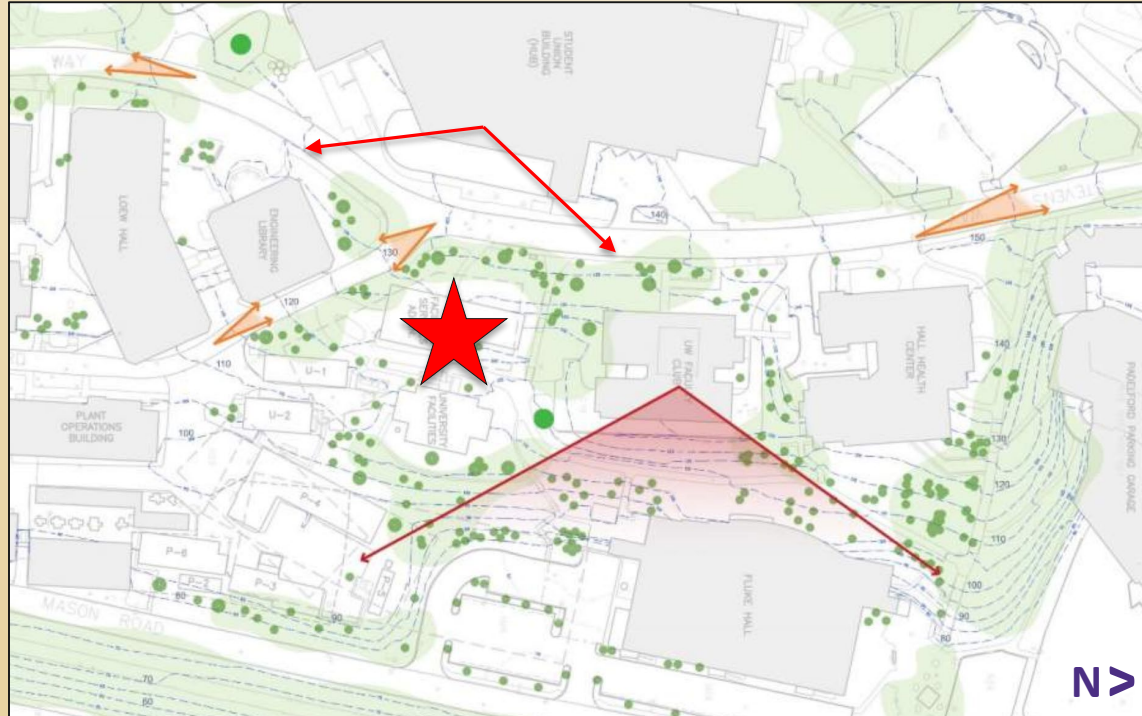

# Pedestrian Connections

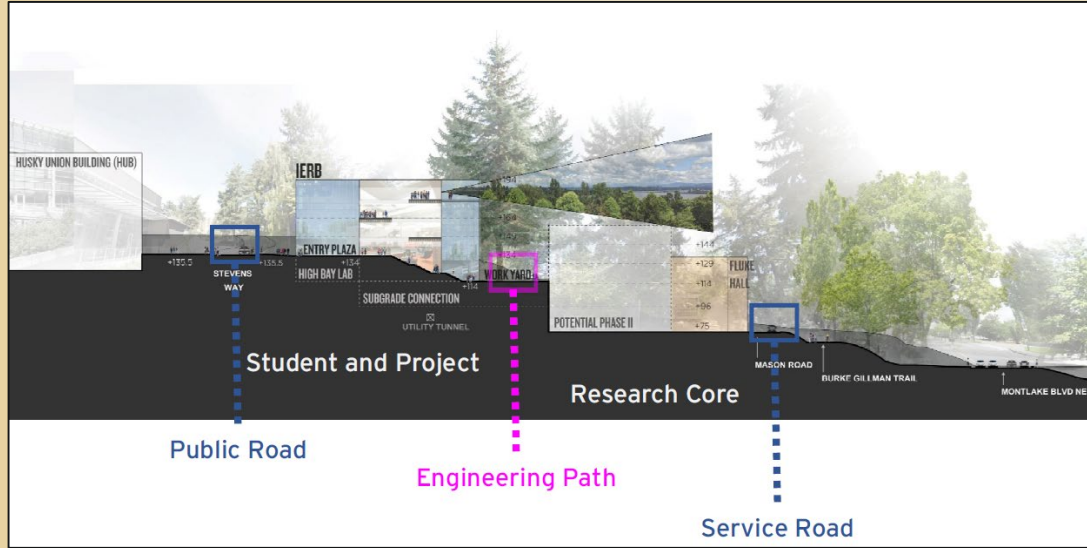

## The "Engineering" Mid Slope Path

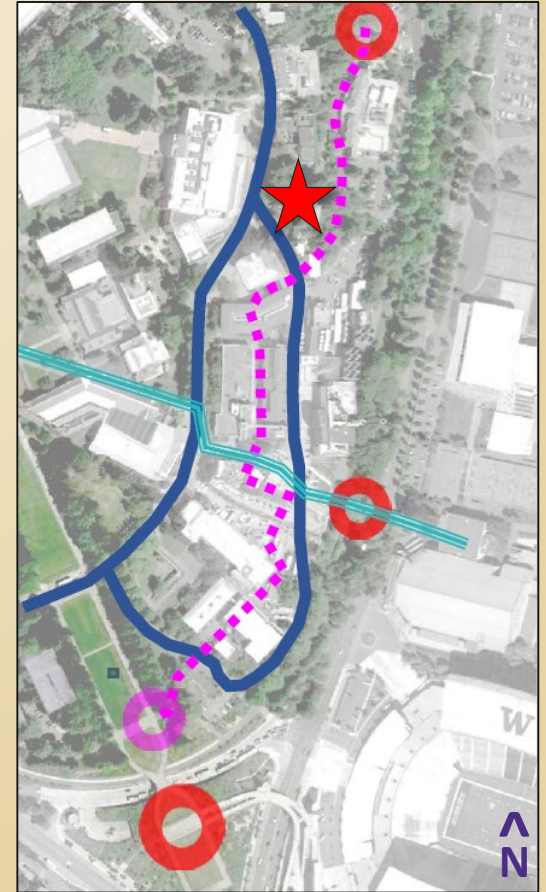

# Project Summary

- > Site C11
- > +/- 75,000 GSF
- > \$909 per GSF

