



INTERCOLLEGIATE ATHLETICS BASKETBALL TRAINING FACILITY

PROJECT CONTACTS

Bob Dillon
Construction Project Manager
 Project Delivery Group
 bdillon@uw.edu | 206.423.5155



Sydney Thiel
Project Manager
 Project Delivery Group
 sydthiel@uw.edu | 206.960.2417



ABOUT THE PROJECT

- 36,000 sf (new facility) + 4,000 sf (interior renovation) = 40,000 sf total project
- 2 stories in height (approximately 40')
- Supports Men's and Women's Basketball programs
- Direct Connections to Hec Ed and Graves Annex for all athletes



CLICK OR SCAN TO LEARN MORE

SUMMARY OF UPCOMING ACTIVITIES (March 15th - April 30, 2024)

The project has officially kicked off and is now in the construction phase. Site fence is up and there is no parking in the E9 parking lot. Within the site, there will be vac trucking and excavation as the installation of new utilities starts up. Inside the pool pavilion, selective demo and abatement activities are underway. Additionally, some interior work will begin in Graves Annex and Hec Ed, to prepare for the pool demolition, which starts at the end of May.

IMPACT BULLETIN

IMPACT TYPE	INFORMATION	IMPACT DATES
NOISE	<ul style="list-style-type: none"> • Graves Annex Steam Pipe Re-route • Hec Ed Steam Tunnel • Band Room Remodel • Vac trucking for Utilities 	<ul style="list-style-type: none"> • Mar 18 - May 30 • Mar 8 - June 6 • Apr 08- Aug 1 • Mar 18 - May 17
ODOR	<ul style="list-style-type: none"> • Switchover of gas line • Demo of Pool Pavilion 	<ul style="list-style-type: none"> • Apr 15 - Apr 19 • May 31 - July 5
CLOSURES/ TRANSPORT	<ul style="list-style-type: none"> • Bike Lane Closed intermittently during gas line install • Pedestrian walk/bike path re-routed by Pool Pavilion 	<ul style="list-style-type: none"> • Mar 25 - Apr 26 • Mar 1 - Aug 2025

UPCOMING MILESTONES

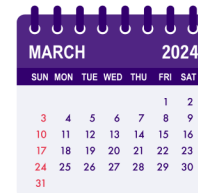



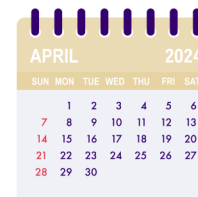

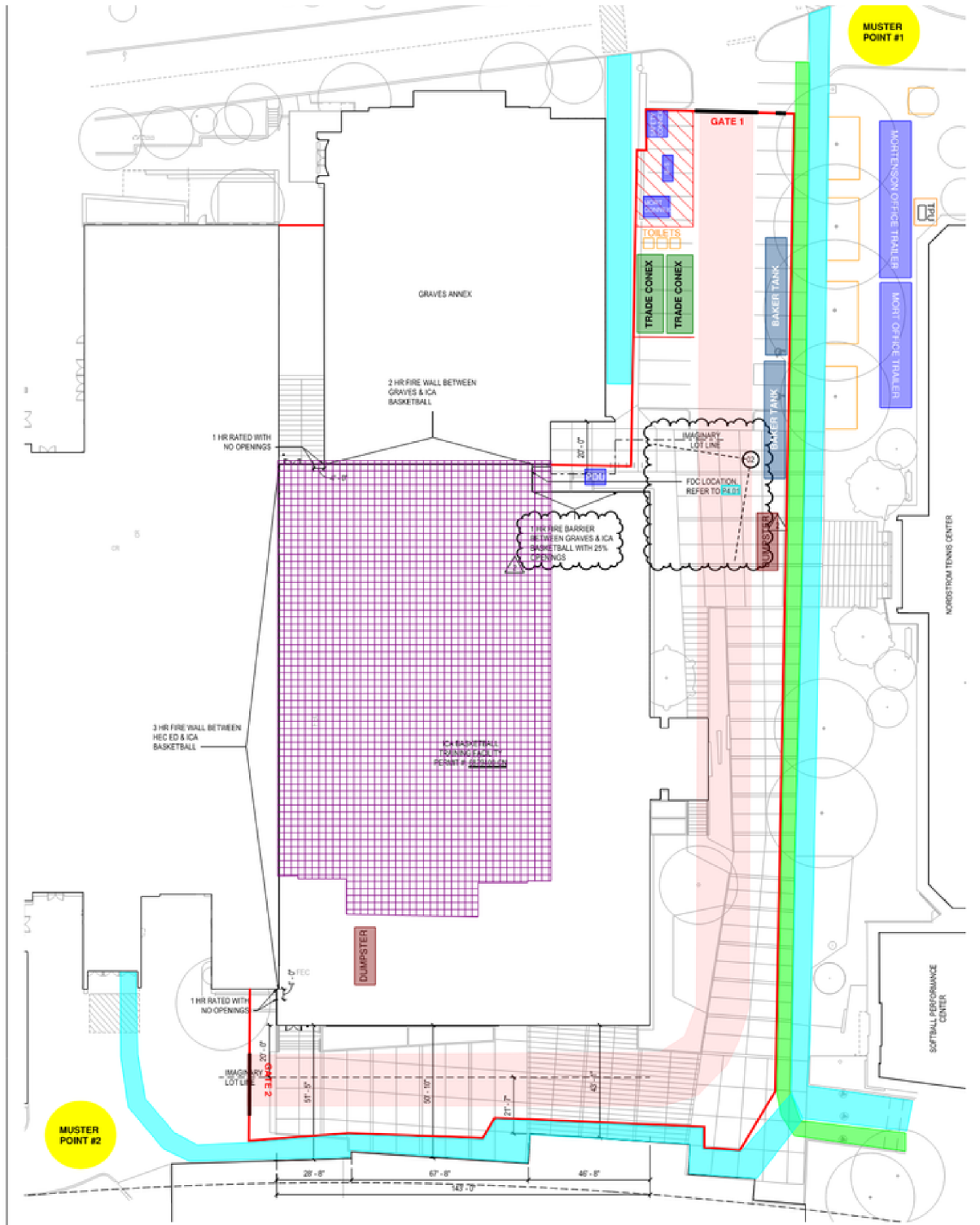

- *Mar 14: Selective Demo Starts inside Pool Pavilion*
- *Mar 18: Graves Annex Work Starts*



- *Apr 8-19: Band Room move-out*
- *Apr 22: Band Room Remodel Starts*
- *Apr 15: Gas Line Switchover*



Site Logistics Legend

-  Existing Building Footprint
-  Pedestrian Walk Path
-  Bike Path
-  Fire Lane
-  Office Trailers
-  Site Fence